

RCD
RCD PROTECTED
DOUBLE GPO

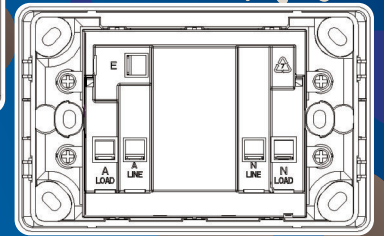
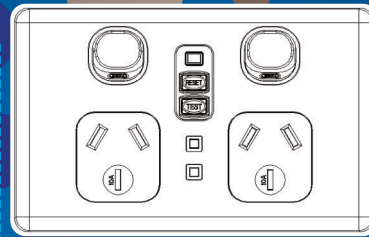

30mA
TRIP RCD

2x10A
GPO

TESRCDGPO230MA

- Built-in RCD to prevent electric shocks
- LED status indicators
- Reset and test buttons



BOX CONTENTS:

- 1 x RCD Protected Double GPO
- 2 x Mounting Screws

Designed to be a directed replacement for your standard GPO fittings, combining two standard 240AC 10A mains (GPO) outlets with a built-in RCD to provide protection against electrical shock. In the event of a fault with the connected appliance or accident, such as cutting through the mains lead, the unit will provide complete isolation from mains. A test button, status indicator, and reset button allows you to check the RCD, which we recommend should be done each time before use. Meets Australian and New Zealand safety standards.

SPECIFICATIONS:

RCD Classified	Type II
Rated Voltage/Current	230-240VAC, 50Hz/2 x 10A
Rated Tripping Current	30mA
Operating Speed	<40mS Max.
L/Nin-L/Out	2KV
Endurance	2000 Cycles Min.
Contact Break	Double Pole
Switch Contact Break	Single Pole
Standards	RCD Module-AS NZS 3190. Socket-AS NZS 3112
Minimum Back Box Depth	35mm
Fixing Screws	M3.0 x 25mm
Cable Capacity	4x2.5mm ² , 1x6mm ²
IP Rating	IP30
Weight	144g
Dimensions	120(W) x 76(H) x 50(D)mm



Please email all orders to
sales@gtsonline.com.au

Electrical Best Pty Ltd ABN: 38 631 960 711, trading as
General Trade Supplies
36 Terrence Road Brendale Qld 4500
Ph : + 61 7 3881 6115 FAX : + 61 7 3881 6120